

Configure a Model Number

Output Shaft Orientation

Type	Prefix
Universal Direction (Maintenance Free)	N

Mounting Style

Type	Prefix
Shaft Mount (Hollow Shaft)	Y
Flange (Solid Shaft)	F
Foot (Solid Shaft)	H

Input Connection

Input Connection	Prefix
C-Face Adapter with jaw coupling	J
Quill C-Face	X
Motor	JM

Modification

	Prefix
Special	S
Standard	

Frame Size

1120	1520
1220	1530
1230	1531
1320	1540
1330	1630
1340	1631
1420	1632
1430	1640
1440	

Output Shaft Direction (shafted model only)

Direction (when viewed from motor end)	Suffix
Projects to Left Side	L
Projects to Right Side	R
Projects to Both Sides	T

Include the following information when ordering:

- Motor Specification (230/460 VAC 60 Hz is supplied, unless otherwise specified)
- NEMA frame size for C-face adapter with jaw coupling or Quill adapter
- Bushing Bore size (must be supplied)
- Optional conduit box positions must be specified, otherwise Y1 is supplied.

Speed Reducers

Nomenclature

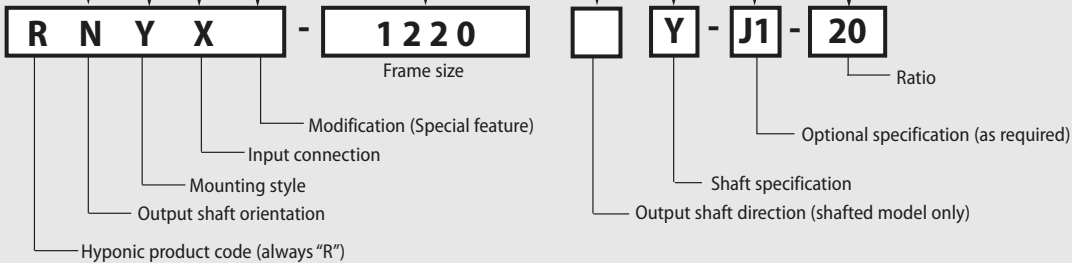

Nomenclature

Shaft Specifications

Input Shaft	Output Shaft		Suffix
	Hollow	Solid	
mm	Key (mm)	Key (mm)	
Inch	Key (Inch)	Key (Inch)	Y

Optional Specifications (as required)

Specification	Suffix
Hollow Bore Options	
Extended Flange (for motor clearance)	
Left (viewed from motor end)	F1
Right (viewed from motor end)	G1
Solid Shaft Options	
Plug-in Shaft	X1
Plug-in Shaft with Bolt-on Feet	
Bottom	J1
Opposite from Motor	S1
Top	M1
Plug-in Shaft with Extended Flange (for motor clearance)	
Left (viewed from motor end)	P1
Right (viewed from motor end)	Q1

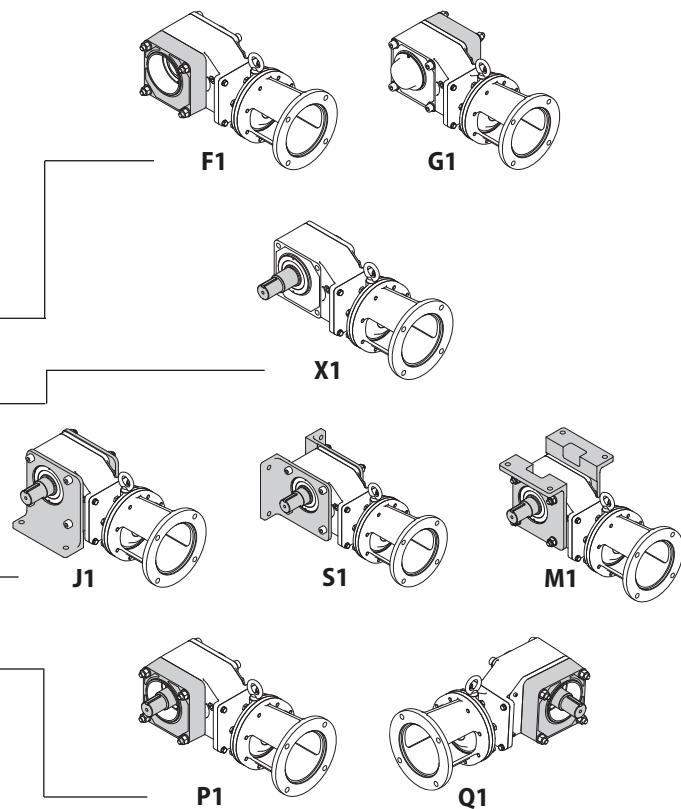

Nominal Total Ratio

5	20	60	200	600
7	25	80	240	720
10	30	100	300	900
12	40	120	360	1200
15	50	150	480	1440

Nomenclature Example:

RNYX – 1220Y – J1 – 20

R – Hyponic® **1220** – Frame Size
N – Universal Mount **Y** – Inch Shaft Specification
Y – Shaft Mount (Hollow Shaft) **J1** – Bolt-on Feet, Bottom
X – Quill C-Face Input **20** – Ratio

Speed Reducers

Nomenclature