

SIZE MATTERS

Sumitomo Drive Technologies

Taper-Grip Bushing® XL for the Cyclo® Bevel Buddybox® (BBB)

Short shaft giving you problems? We have options!

With our **all new** Taper-Grip Bushing® XL, you get all the great features of our standard taper-grip option, now modified to accept shorter shafts.

Taper-Grip Bushing® XL allows for an easy installation, of the reliable BBB unit, to the available shaft length.

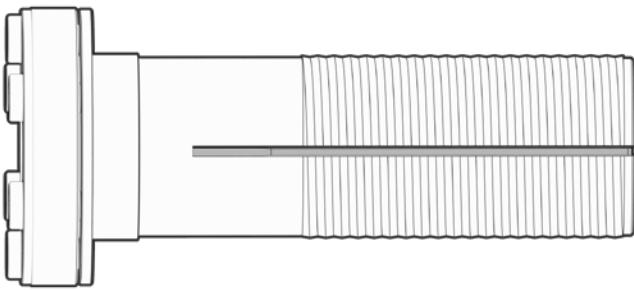

Available shaft is too short. ($L < \min TT$)

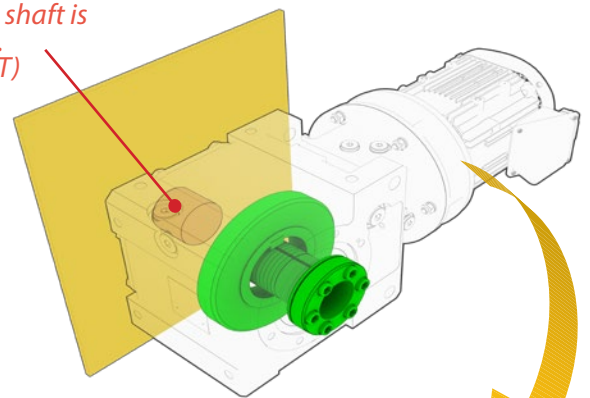

Minimum Required Available Shaft Length

Size	TT		TT XL	
	mm	in	mm	in
4A	208	8.19	110	4.33
4B	242	9.53	120	4.72
4C	279	10.98	150	5.91
4D	326	12.83	175	6.89
4E	359	14.13	190	7.48

-TT is the minimum required shaft length for proper standard TGB engagement
 -TT XL is the minimum required shaft length for proper TGB XL engagement
 -TT XL = Order Code SSC: YB4Z

www.SumitomoDrive.com

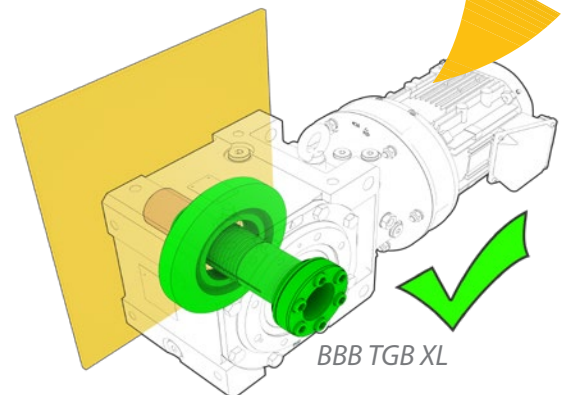

BBB TGB XL

Sumitomo Machinery Corporation of America

Sumitomo Drive Technologies

A global power transmission solutions provider. With facilities strategically located throughout the world, providing comprehensive products and services in your region.

Headquarters

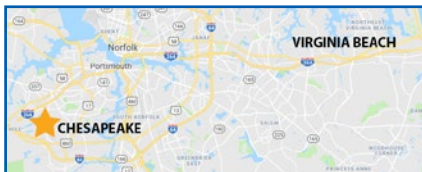

4200 Holland Blvd
Chesapeake, VA 23323

email: SMA.CustomerService@shi-g.com

phone: 757-485-3355

- ★ MANUFACTURING HUB & HEADQUARTERS
- ★ MANUFACTURING HUB
- ASSEMBLY & SERVICE
- ▲ REGIONAL SALES OFFICE

